



67 Hawfield Lane

, Burton-On-Trent, DE15 0BX

£950 Per Calendar Month

This recently renovated two-double-bedroom semi-detached home is being offered for sale with no upward chain. It is close to all local amenities. The gas-centrally heated accommodation offers a new boiler and replacement radiators, a new modern, fitted kitchen and bathroom, neutral décor throughout, and new carpets and flooring. The layout offers an entrance hall with stairs off to the first floor, a lounge of good size, a modern fitted kitchen, a guest cloakroom, a utility room, and a conservatory. On the first floor are two double bedrooms and a well-fitted modern bathroom with a shaped bath. Outside, shared entry steps lead to the front of the property, and a slightly elevated garden is to the rear. Available Now EPC D

Viewing

Please contact our Scargill Mann & Co Residential Lettings Office on 01332 206620 if you wish to arrange a viewing appointment for this property or require further information.

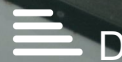

Floor Plan

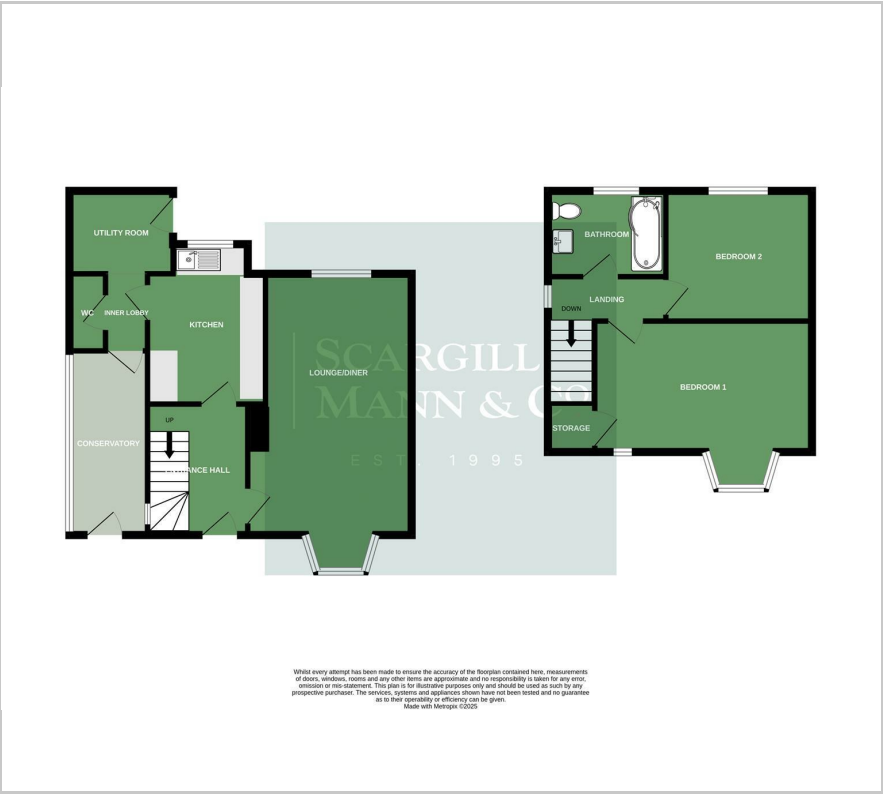

Area Map



Energy Efficiency Graph

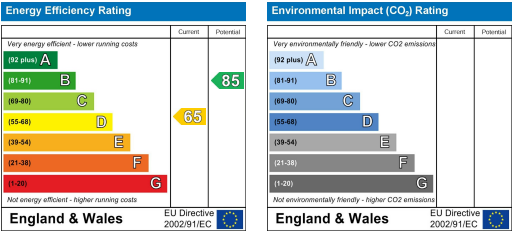

These particulars, whilst believed to be accurate are set out as a general outline only for guidance and do not constitute any part of an offer or contract. Intending purchasers should not rely on them as statements of representation of fact, but must satisfy themselves by inspection or otherwise as to their accuracy. No person in this firms employment has the authority to make or give any representation or warranty in respect of the property.