



Apartment 2
7a Park Farm Centre
Park Farm Drive Allestree
Derby
DE22 2QN

Price
£95,000

- First floor apartment
- Close to University & local amenities
- Electric central heating
- Entrance hallway
- Living/Dining kitchen
- One bedroom
- Bathroom
- Permit parking available
- No upward chain
- IDEAL INVESTMENT OPPORTUNITY

SCARGILL
MANN & CO

EST. 1995

GENERAL INFORMATION

A rare opportunity to acquire this recently converted, well appointed one bedroom first-floor apartment finished to a high standard. Being situated at the Park Farm Centre at Allestree, the apartment is situated in a highly convenient location within Allestree. The apartment is ideal for a professional person, first time buyer or investor, with a likely rental return of £525pcm.

The apartment is sold with the benefit of no upward chain, electric central heating, sealed unit UPVC double glazing and an allocated residents parking permit. Internally the accommodation briefly comprises entrance hallway, first bedroom, bathroom and fitted open plan living/dining/kitchen.

LOCATION

The property occupies a position in the heart of the Park Farm Shopping Centre, which has a comprehensive range of popular shops, cafés, gymnasiums and also within easy access of local schools, the popular Markeaton and Allestree Parks. There is swift access into Derby City centre and the University of Derby.

ACCOMMODATION

ON THE GROUND FLOOR

COMMUNAL ENTRANCE HALL

ON THE FIRST FLOOR

Wooden door providing access to:

APT 2 - RECEPTION HALLWAY

Recessed LED lighting, electric radiator, intercom system and doors to all rooms.

STORAGE CUPBOARD

Housing water tank and electric circuit board.



LIVING KITCHEN/DINER

5.18 x 4.40 (17'0" x 14'5")

Preparation surfaces with matching up-stands, inset stainless steel sink and drainer unit with chrome mixer tap over, a range of cupboards and drawers under with integrated fridge, washing machine/dryer, fan assisted oven with electric four ring hob and extractor canopy over, complementary wall mounted cupboards, recessed LED, electric radiator and upvc double glazed window to front.

BEDROOM

3.67 x 2.95 (12'0" x 9'8")

Electric radiator, upvc double glazed windows to front, recessed LED lighting and TV aerial.

BATHROOM

2.06 x 1.57 (6'9" x 5'2")

Partially tiled white suite comprising wall hung wash hand basin with chrome mixer tap over and drawer under, low level w.c., bath with chrome mixer tap and shower over with side screen, recessed LED lighting, extractor fan, electric shaver point, chrome ladder style heated towel rail.

OUTSIDE

...

The apartment has one parking permit (free of charge).

TENURE

This property is Leasehold on a lease of 125 years. The service charge is approx £128 per annum with a ground rent of £100 per annum and buildings insurance of approx £144 per annum.

COUNCIL TAX BAND

Derby City - Band TBC

DIRECTIONAL NOTE

....

From our Derby office proceed along the main Kedleston Road, travelling to Allestree. When approaching Allestree, turn right into Birchover Way, proceed along Birchover Way for approximately 1 mile then take the turning right into Park Farm Drive. The apartments are situated within the shopping centre.

VIEWING

.....

Strictly by appointment through Scargill Mann & Co - Derby office (JS/SE).

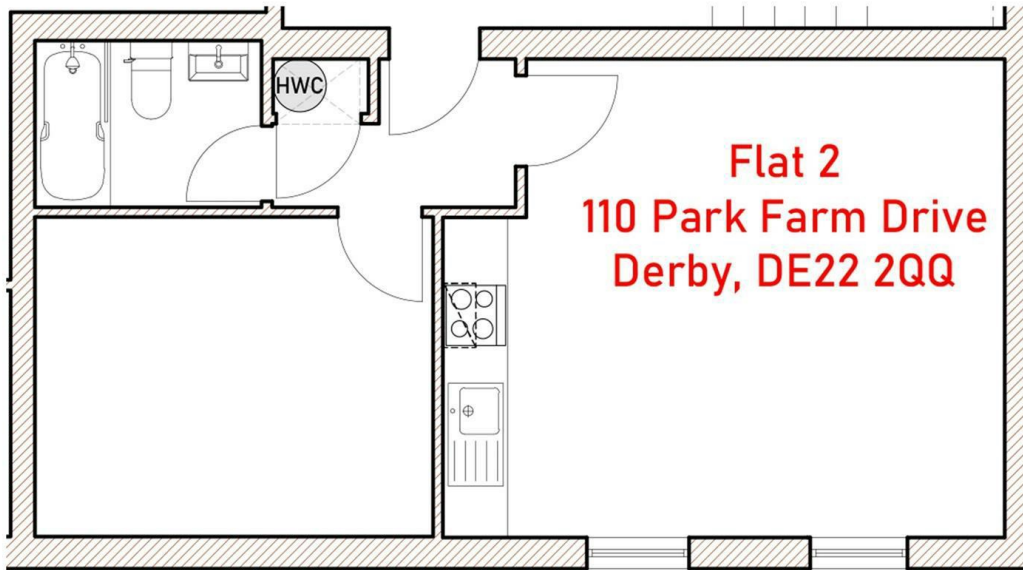

Energy Efficiency Rating		
	Current	Potential
Very energy efficient - lower running costs		
(92 plus) A		
(81-91) B		
(69-80) C		
(55-68) D	64	64
(39-54) E		
(21-38) F		
(1-20) G		
Not energy efficient - higher running costs		
England & Wales	EU Directive 2002/91/EC	

ASHBOURNE

8 Market Place
Ashbourne
Derbyshire
DE6 1ES

T: 01335 345460

E: ashbourne@scargillmann.co.uk

BURTON UPON TRENT

Unit 17 Eastgate Business Centre
Eastern Avenue
Burton upon Trent
DE13 0AT

T: 01283 548194

E: burton@scargillmann.co.uk

DERBY

4 St James's Street
Derby
DE1 1RL

T: 01332 207720

E: enquiries@scargillmann.co.uk

MATLOCK

3 Parkside
Olde Englishe Road, Off Dale Road
Matlock
DE4 3SX

T: 01629 584591

E: matlock@scargillmann.co.uk

DERBY LETTINGS

4 St James's Street
Derby
DE1 1RL

T: 01332 206620

E: lettings@scargillmann.co.uk

www.scargillmann.co.uk